

FOR LEASE ±48,772 SF

INDUSTRIAL BUILDING

2091 Raymer Avenue, Fullerton, CA



Property Features

- State of the Art Distribution Building
- ±2,653 SF of Office Area
- Part of a Larger 70,414 SF Building
- Ten (10) Dock High Loading Doors
- One (1) 12' x 12' Ground Level Doors
- One (1) 22' x 20' Ground Level Door
- 30' Warehouse Clearance
- 600 Amps of Power
- ESFR Fire Sprinkler System
- Convenient Access to 5, 91 and 57 Freeways



MIKE HEFNER, SIOR
Executive Vice President
714.935.2331
Lic. #00857352
mhefner@voitco.com

JACK FARIS, SIOR
Senior Vice President
714.935.2318
Lic. #00912766
jfaris@voitco.com

Voit
REAL ESTATE SERVICES

**HEFNER
VERNICK
TEAM**

FOR LEASE ±48,772 SF

INDUSTRIAL BUILDING

2091 Raymer Avenue, Fullerton, CA

SITE PLAN

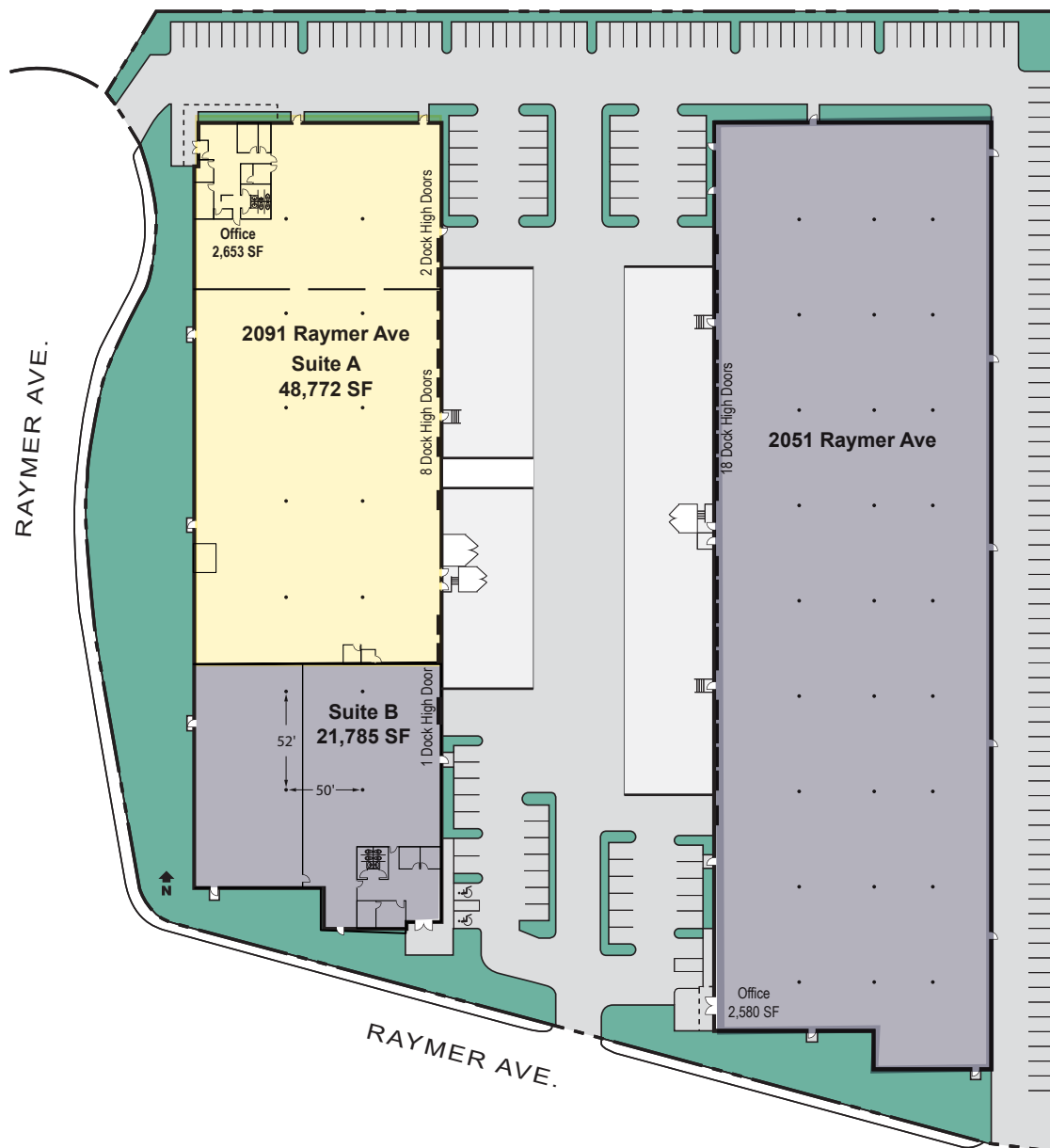

* Site plan not to scale.

MIKE HEFNER, SIOR
Executive Vice President
714.935.2331
Lic. #00857352
mhefner@voitco.com

JACK FARIS, SIOR
Senior Vice President
714.935.2318
Lic. #00912766
jfaris@voitco.com

Voit
REAL ESTATE SERVICES

**HEFNER
VERNICK
TEAM**

Property Touring Guidelines >

2400 E. Katella Ave., Suite 750, Anaheim, CA 92806 • 714.978.7880 • 714.978.9431 Fax

www.HefnerVernickTeam.com

Licensed as Real Estate Broker by the CA Bur of Real Estate. The information contained herein has been obtained from sources we deem reliable. While we have no reason to doubt its accuracy, we do not guarantee it. ©2021 Voit Real Estate Services, Inc. All Rights Reserved. License #01991785.