

FOR SALE

Industrial Units from ±5,988 to 30,000 Sq. Ft.

Voit

REAL ESTATE SERVICES



1050 W. Central Avenue, Brea

Property Features:

- Multiple Sizes Ranging from ±5,988 to 30,000 Sq. Ft.
- Major Street Frontage
- 19' Minimum Warehouse Clearance
- Drive Around Building Vehicle Access
- Abundant Skylights and Warehouse Lighting
- Professionally Maintained Business Park Environment
- Fire Sprinklers
- Oversized Ground Level Loading Doors (14' x 14')
- Fully Refurbished Units
- Functional Office Layouts with Ample Natural Light
- Excellent Access to the 57 Freeway
- Purchase with only 10% Down Payment

Real People. Real Solutions.®

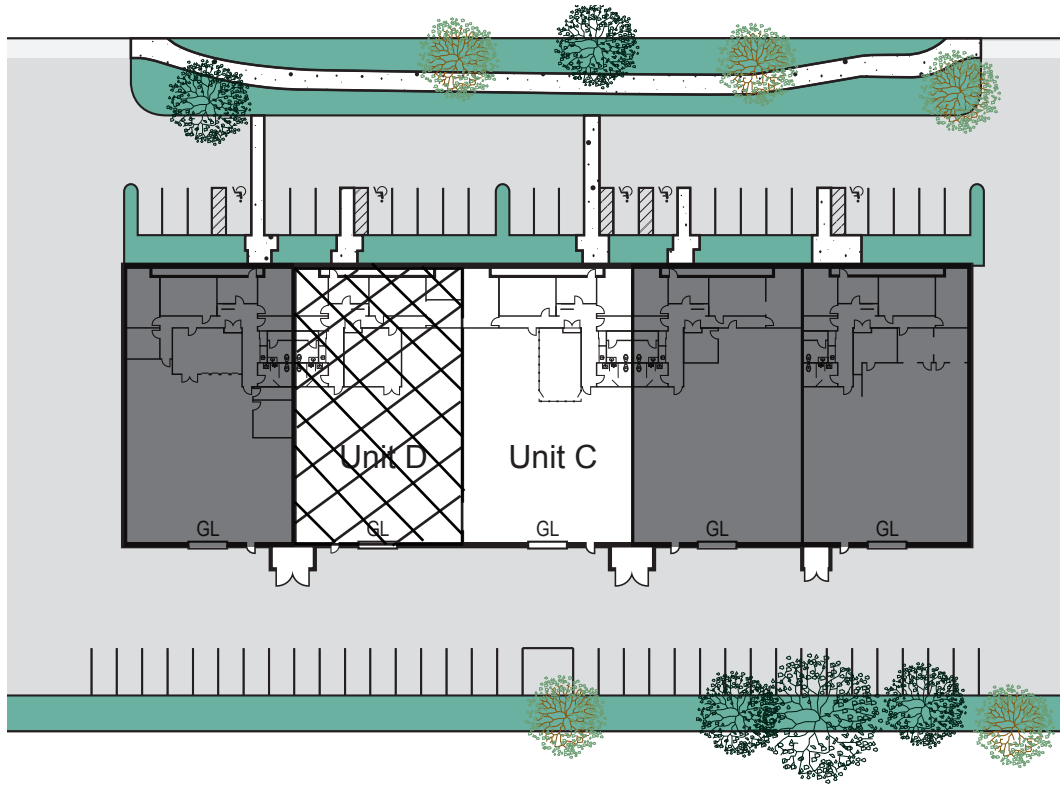

FOR SALE ±5,988 to 30,000 Sq. Ft.

1050 W. Central Avenue, Brea



1050 W. CENTRAL AVENUE

Unit	Unit Sq. Ft.	Office Sq. Ft.	Loading Doors	Sale Price / PSF
C	6,003	1,753	1	\$205.00
D	5,988	2,300	1	\$205.00

-  = Not Currently Available
-  = Sold
-  = Escrow

For further details please visit:

www.breacentral.net

Mike Hefner, SIOR
Executive Vice President
Lic #00857352
714.935.2331
MHefner@voitco.com

Mike Vernick, CCIM, SIOR
Senior Vice President
Lic #01420885
714.935.2354
MVernick@voitco.com

Morgan Hill
Senior Associate
Lic #01877356
714.935.2322
MHill@voitco.com

Voit
REAL ESTATE SERVICES

Another Quality Project By:
GUTHRIE
development

2400 E. Katella Ave., Suite 750, Anaheim, CA 92806 • 714.978.7880 • 714.978.9431 Fax • Lic #01333376 | www.voitco.com

Licensed as a Real Estate Broker by the CA Bur of Real Estate. The information contained herein has been obtained from sources we deem reliable. While we have no reason to doubt its accuracy, we do not guarantee it. ©2015 Voit Real Estate Services, Inc. All Rights Reserved. Real People. Real Solutions.® is a registered trademark of Voit Real Estate Services.