

FOR LEASE ±39,139 SF

STATE-OF-THE-ART INDUSTRIAL BUILDING

2051 Raymer Ave., Unit B, Fullerton



Property Features

- State-of-the-Art Distribution Building
- Approximately 2,967 Sq. Ft. of Office Space
- 9 Dock High Loading Doors
- 1 Ground Level Loading Ramp
- 180' Truck Court
- ESFR Fire Sprinkler System
- 30' Interior Warehouse Clearance
- Strategically Located at the Intersection of the 5 and 91 Freeways



MIKE HEFNER, SIOR
Executive Vice President
714.935.2331
Lic. #00857352
mhefner@voitco.com

JACK FARIS
Senior Vice President
714.935.2318
Lic. #00912766
jfaris@voitco.com

Voit
REAL ESTATE SERVICES

FOR LEASE ±39,139 SF

STATE-OF-THE-ART INDUSTRIAL BUILDING

2051 Raymer Ave., Unit B, Fullerton

SITE PLAN

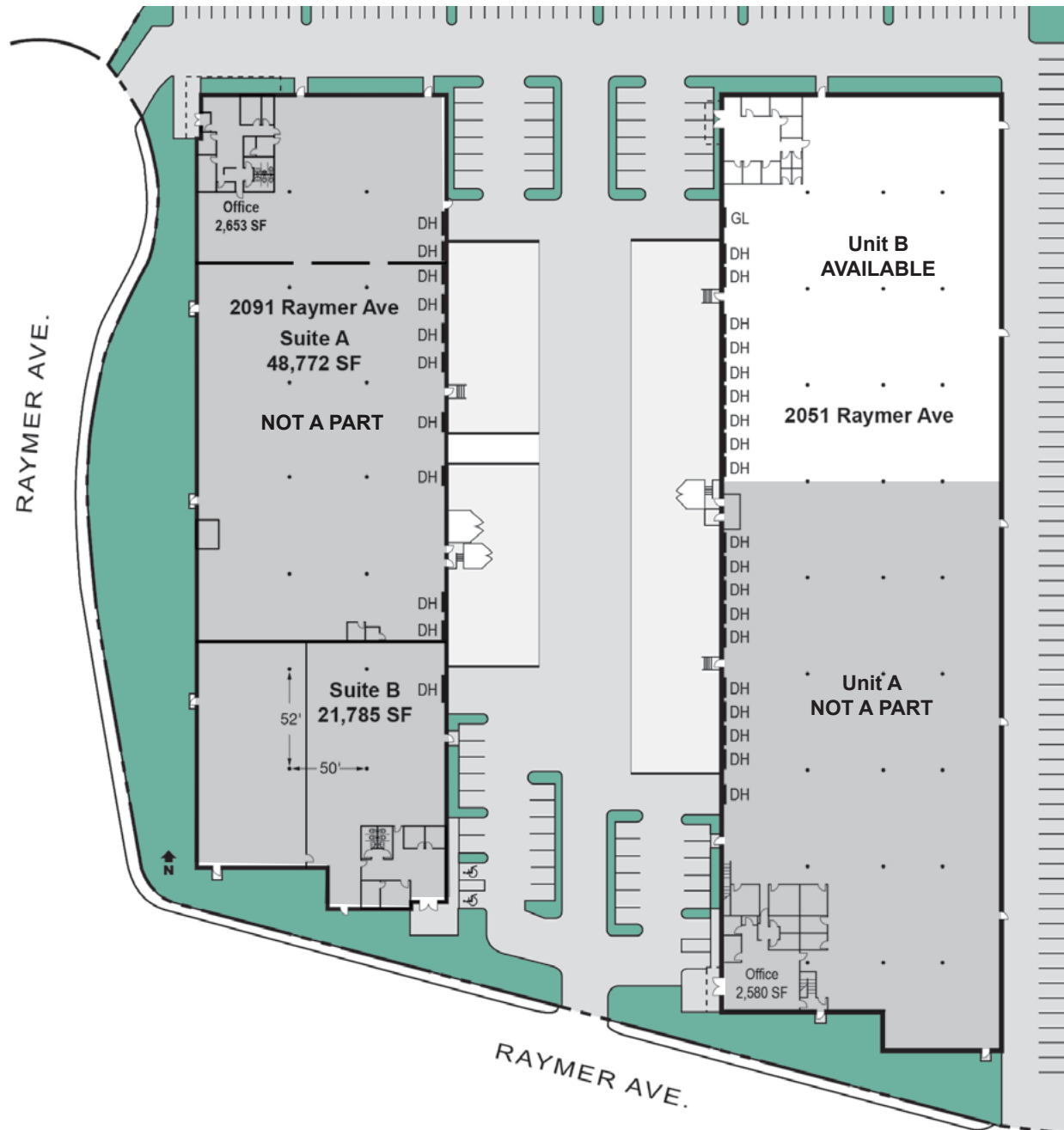

MIKE HEFNER, SIOR
Executive Vice President
714.935.2331
Lic. #00857352
mhefner@voitco.com

JACK FARIS
Senior Vice President
714.935.2318
Lic. #00912766
jfaris@voitco.com

Voit
REAL ESTATE SERVICES

2400 E. Katella Ave., Suite 750, Anaheim, CA 92806 • 714.978.7880 • 714.978.9431 Fax

www.VoitCo.com

Licensed as Real Estate Broker and Salesperson by the CA Bur of Real Estate. The information contained herein has been obtained from sources we deem reliable. While we have no reason to doubt its accuracy, we do not guarantee it. ©2018 Voit Real Estate Services, Inc. All Rights Reserved. License #0133376.