

FOR LEASE ±5,000 SF

INDUSTRIAL FOR LEASE

1241 N. Simon Circle, Anaheim



Property Features

- 700 Sq. Ft. of Office Area
- 12' Warehouse Clearance
- 400 Amps of 277/480 Volt Power
- 10 Parking Stalls
- 1 Ground Level Door
- Fenced Yard
- Low Cost Anaheim Utility Rates
- Located in Prestigious Canyon Corridor
- Convenient Access to Riverside (91), Pomona (57) and Newport (55) Freeways



MIKE HEFNER, SIOR
Executive Vice President
714.935.2331
Lic. #00857352
mhefner@voitco.com

Voit
REAL ESTATE SERVICES

HV HEFNER
VERNICK
TEAM

FOR LEASE ±5,000 SF

INDUSTRIAL FOR LEASE

1241 N. Simon Circle, Anaheim

SITE PLAN

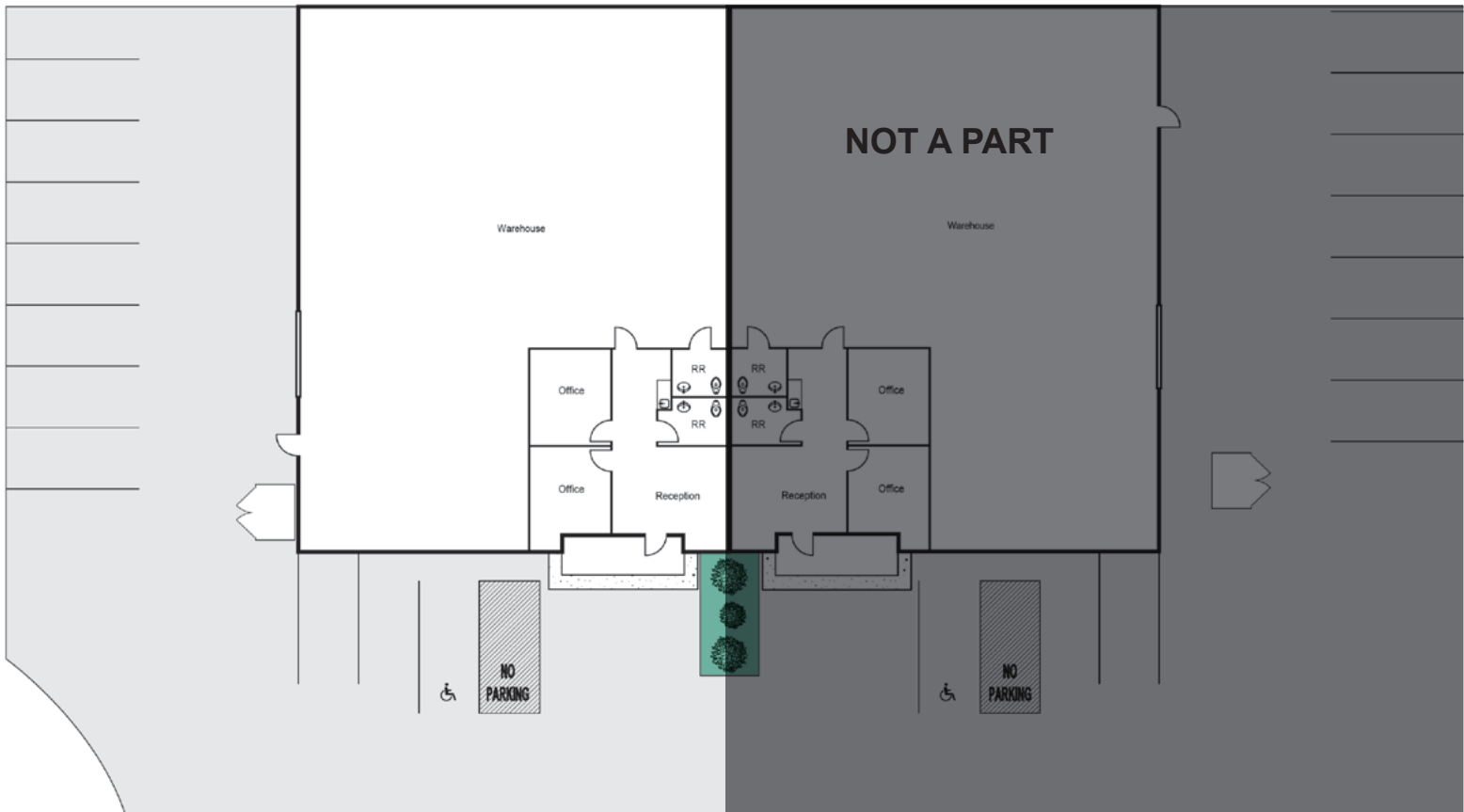

MIKE HEFNER, SIOR
Executive Vice President
714.935.2331
Lic. #00857352
mhefner@voitco.com

Voit
REAL ESTATE SERVICES

HV HEFNER
VERNICK
TEAM

2400 E. Katella Ave., Suite 750, Anaheim, CA 92806 • 714.978.7880 • 714.978.9431 Fax

Licensed as Real Estate Broker(s) and Salesperson by the CA Bur of Real Estate. The information contained herein has been obtained from sources we deem reliable. While we have no reason to doubt its accuracy, we do not guarantee it. ©2017 Voit Real Estate Services, Inc. All Rights Reserved. License #0133376.

www.HefnerVernickTeam.com
www.VoitCo.com